

**DIRECT ACTING
PRESSURE REGULATOR**



geca

**Tecno
Control**

WE'RE A RESILIENT GROUP

Being a Group means having the culture, expertise, service and products the Customer needs to succeed.

CPF Industriale, Geca and Tecnocontrol have been created to meet market demand in real time, to show credibility and structural strength.

It's true. We're a resilient group because in over 70 years we have been able to understand and bring technology, products and customer service in line with the real needs of our Customers, who have changed incredibly over time. We have placed extreme attention on listening, analysing and studying without interfering with the final goal:

Uncompromised Quality.

Our Group is currently able to design, manufacture and sell in the OEM, Industrial Gas Companies, Plumbing and Heating, HVAC, Gas distribution, Gas Safety and Oil & Gas sectors and operates in 91 countries worldwide.



DIRECT ACTING PRESSURE REGULATOR Pmax 20 bar

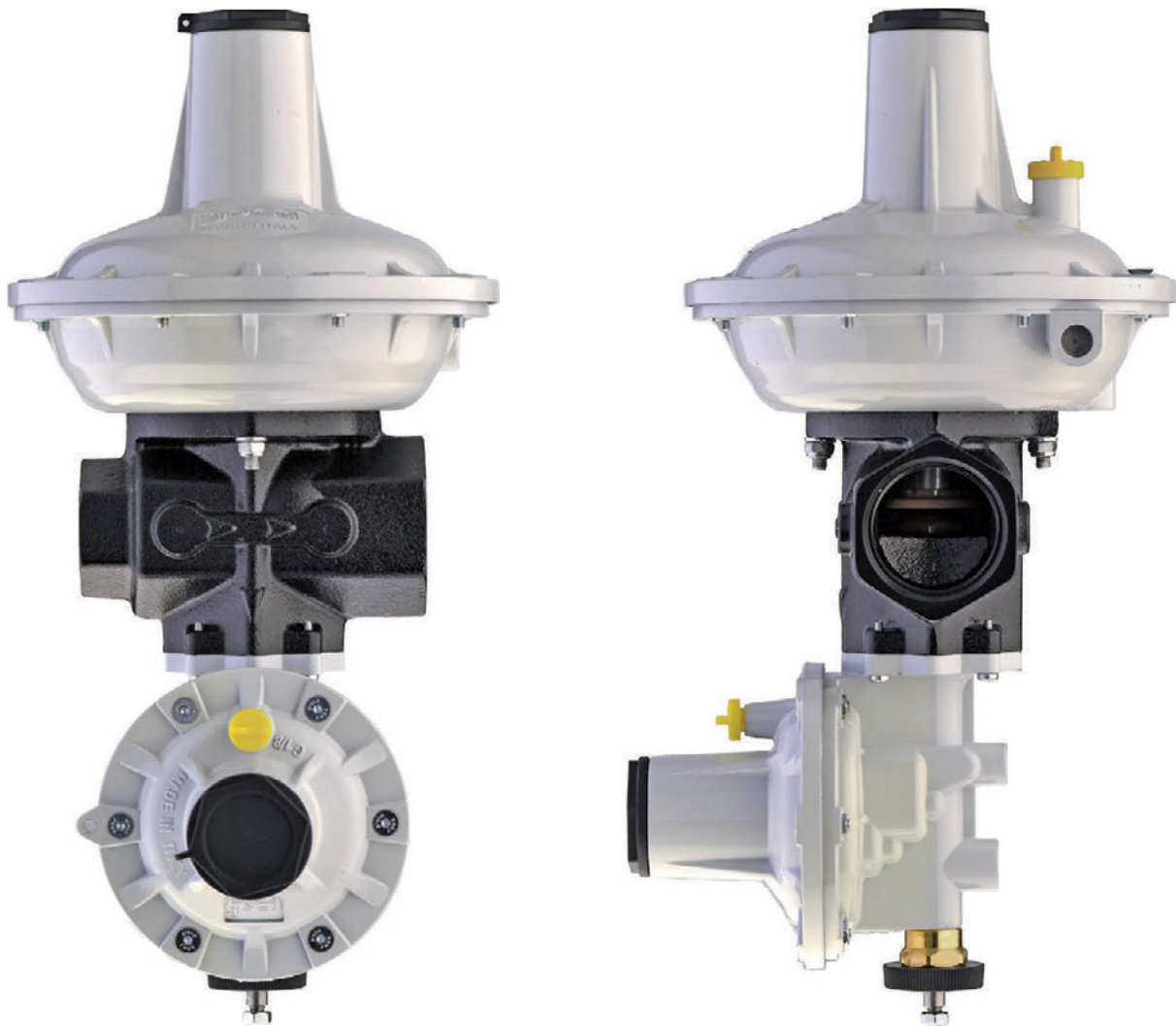

HORIZONTAL VERSION / Head of Regulator

The **RG Series** is a direct-acting pressure regulator with balanced plug, for low, medium and high pressures. Suitable for non-corrosive gases; thanks to the concept of a balanced plug, you can achieve a high flow rate coefficient, highly accurate (even at maximum flow rates), a lock up zone and relatively low lock up pressure, no internal leakage at zero flow rate and reduced response times.

The constancy of the regulated pressure and its accuracy, even with significant changes in the upstream pressure and/ or flow rate, make the **RG Series** regulator especially suitable for power distribution networks in civil and industrial plants. The basic version of the **RG Series** regulator is made according to European Standard **EN 334**, as a **Fail to Open regulator**.

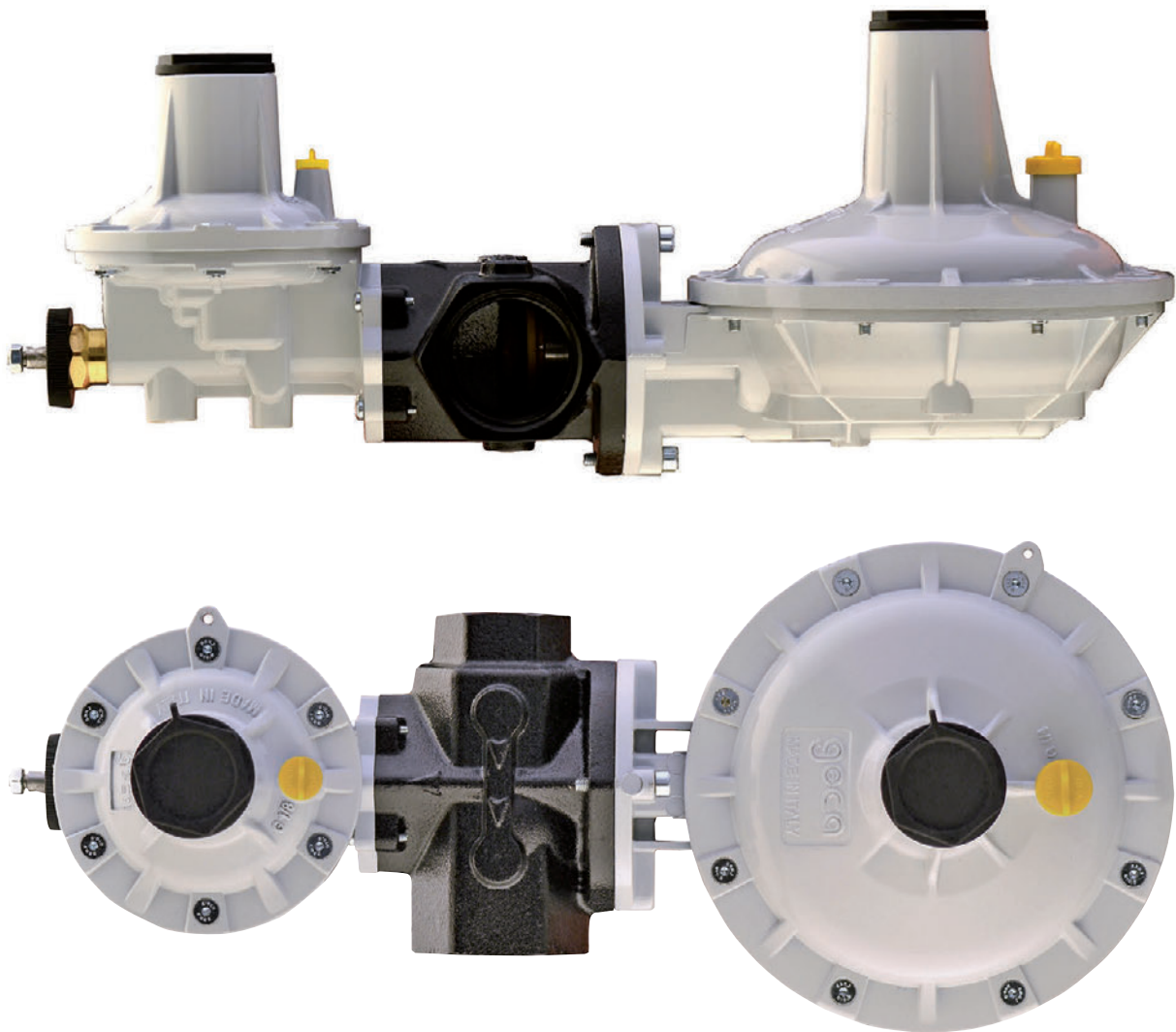

VERTICAL VERSION / Head of Regulator

The shut-off device can be calibrated for pressure increase, **Over Pressure Shut-Off (OPSO)** and/or for pressure decrease, **Under Pressure Shut-Off (UPS0)**. The two intervention modes can be calibrated independently by dedicated calibration springs: one spring for the maximum pressure intervention and the second spring for the minimum pressure intervention. **RG series can be supplied also without Slam Shut valve.**

The **RG Series** can be equipped with an incorporated relief valve that discharges the gas into the atmosphere when the regulator outlet pressure exceeds the set value. When the outlet pressure returns to below the set value, the relief valve closes again.

The **MONITOR** is a safety accessory that performs the functions of the service regulator when the main regulator fails. This is a regulator valve that is usually fully open during normal operation of the service regulator. The **MONITOR** is an emergency pressure regulator that is usually upstream, in the direction of the gas flow, of another pressure regulator that performs the function of a **SERVICE** regulator.

OPERATING FEATURES

Maximum inlet pressure (Pu)	10 bar for LP version 20 bar for MP and HP version
Outlet pressure (Pd)	20 mbar to 4 bar * (<i>refer to the table</i>)
Slam Shut valve	OPSO 30 mbar to 5,5 bar * (<i>refer to the table</i>) UPSO 6 mbar to 3,5 bar * (<i>refer to the table</i>)
Relief Valve	Pd + 10 mbar to 700 mbar * (<i>refer to the table</i>)
AC Accuracy class	up to 5
SG Lock up class	up to 20
Working Temperature	- 40°C to + 60°C
Dimension	1" - 1" / 1" - 1 1/2" / 1 1/2" - 1 1/2" / 2" - 2" - Threaded DN40 - DN40 / DN50 - DN50 - Flanged
Body	Cast Iron GJS 400-18 Aluminum EN46100 Painted
Diaphragms	Reinforced NBR
O-rings	Nitrile rubber

MAIN FEATURES

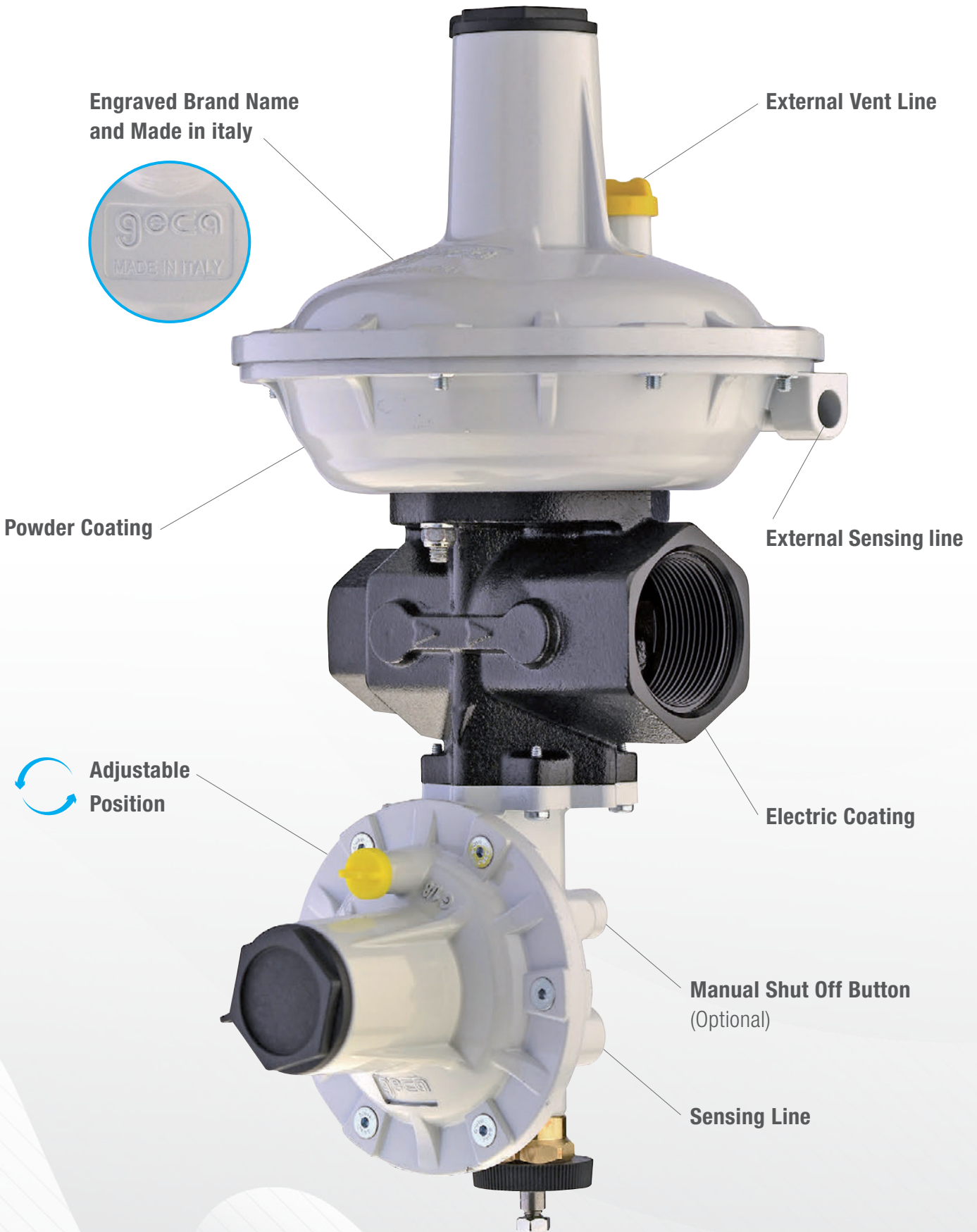

CODE	DESCRIPTION
Body 1" - 1" Threaded - HORIZONTAL VERSION	
RG025 - LP - RV - H	Gas Regulator 1" - 1" - Pmax 10 bar - LP Version - Outlet Range 15 - 110 mbar - Relief 15-110 mbar
RG025 - MP - RV - H	Gas Regulator 1" - 1" - Pmax 20 bar - MP Version - Outlet Range 70 - 300 mbar - Relief 80 - 1100 mbar
RG025 - HP - RV - H	Gas Regulator 1" - 1" - Pmax 20 bar - HP Version - Outlet Range 100 - 3000 mbar - Relief 80 - 3000 mbar
Body 1" - 1 1/2" Threaded - HORIZONTAL VERSION	
RG02540 - LP - RV - H	Gas Regulator 1" - 1 1/2" - Pmax 10 bar - LP Version - Outlet Range 15 - 110 mbar - Relief 15-110 mbar
RG02540 - MP - RV - H	Gas Regulator 1" - 1 1/2" - Pmax 20 bar - MP Version - Outlet Range 70 - 300 mbar - Relief 80 - 1100 mbar
RG02540 - HP - RV - H	Gas Regulator 1" - 1 1/2" - Pmax 20 bar - HP Version - Outlet Range 100 - 3000 mbar - Relief 80 - 3000 mbar
Body 1 1/2" - 1 1/2" Threaded - HORIZONTAL VERSION	
RG040 - LP - RV - H	Gas Regulator 1 1/2" - 1 1/2" - Pmax 10 bar - LP Version - Outlet Range 15 - 110 mbar - Relief 15-110 mbar
RG040 - MP - RV - H	Gas Regulator 1 1/2" - 1 1/2" - Pmax 20 bar - MP Version - Outlet Range 70 - 300 mbar - Relief 80 - 1100 mbar
RG040 - HP - RV - H	Gas Regulator 1 1/2" - 1 1/2" - Pmax 20 bar - HP Version - Outlet Range 100 - 3000 mbar - Relief 80 - 3000 mbar
Body 2" - 2" Threaded - HORIZONTAL VERSION	
RG050 - LP - RV - H	Gas Regulator 2" - 2" - Pmax 10 bar - LP Version - Outlet Range 15 - 110 mbar - Relief 15-110 mbar
RG050 - MP - RV - H	Gas Regulator 2" - 2" - Pmax 20 bar - MP Version - Outlet Range 70 - 300 mbar - Relief 80 - 1100 mbar
RG050 - HP - RV - H	Gas Regulator 2" - 2" - Pmax 20 bar - HP Version - Outlet Range 100 - 3000 mbar - Relief 80 - 3000 mbar
Body DN40 - DN40 Flanged - HORIZONTAL VERSION	
RGD40 - LP - RV - H	Gas Regulator DN40 - DN40 - Pmax 10 bar - LP Version - Outlet Range 15 - 110 mbar - Relief 15-110 mbar
RGD40 - MP - RV - H	Gas Regulator DN40 - DN40 - Pmax 20 bar - MP Version - Outlet Range 70 - 300 mbar - Relief 80 - 1100 mbar
RGD40 - HP - RV - H	Gas Regulator DN40 - DN40 - Pmax 20 bar - HP Version - Outlet Range 100 - 3000 mbar - Relief 80 - 3000 mbar
Body DN50 - DN50 Flanged - HORIZONTAL VERSION	
RGD50 - LP - RV - H	Gas Regulator DN50 - DN50 - Pmax 10 bar - LP Version - Outlet Range 15 - 110 mbar - Relief 15-110 mbar
RGD50 - MP - RV - H	Gas Regulator DN50 - DN50 - Pmax 20 bar - MP Version - Outlet Range 70 - 300 mbar - Relief 80 - 1100 mbar
RGD50 - HP - RV - H	Gas Regulator DN50 - DN50 - Pmax 20 bar - HP Version - Outlet Range 100 - 3000 mbar - Relief 80 - 3000 mbar
Body 1" - 1" Threaded - HORIZONTAL VERSION - Without Relief Valve	
RG025 - LP - H	Gas Regulator 1" - 1" - Pmax 10 bar - LP Version - Outlet Range 15 - 110 mbar
RG025 - MP - H	Gas Regulator 1" - 1" - Pmax 20 bar - MP Version - Outlet Range 70 - 300 mbar
RG025 - HP - H	Gas Regulator 1" - 1" - Pmax 20 bar - HP Version - Outlet Range 100 - 3000 mbar
Body 1" - 1 1/2" Threaded - HORIZONTAL VERSION - Without Relief Valve	
RG02540 - LP - H	Gas Regulator 1" - 1 1/2" - Pmax 10 bar - LP Version - Outlet Range 15 - 110 mbar
RG02540 - MP - H	Gas Regulator 1" - 1 1/2" - Pmax 20 bar - MP Version - Outlet Range 70 - 300 mbar
RG02540 - HP - H	Gas Regulator 1" - 1 1/2" - Pmax 20 bar - HP Version - Outlet Range 100 - 3000 mbar
Body 1 1/2" - 1 1/2" Threaded - HORIZONTAL VERSION - Without Relief Valve	
RG040 - LP - H	Gas Regulator 1 1/2" - 1 1/2" - Pmax 10 bar - LP Version - Outlet Range 15 - 110 mbar
RG040 - MP - H	Gas Regulator 1 1/2" - 1 1/2" - Pmax 20 bar - MP Version - Outlet Range 70 - 300 mbar
RG040 - HP - H	Gas Regulator 1 1/2" - 1 1/2" - Pmax 20 bar - HP Version - Outlet Range 100 - 3000 mbar

Range mentioned in above description is the full range . It is possible to get with different springs. \ Please select the right spring from the table in the product catalogue.

CODE	DESCRIPTION
Body 2" - 2" Threaded - HORIZONTAL VERSION - Without Relief Valve	
RG050 - LP - H	Gas Regulator 2" - 2" - Pmax 10 bar - LP Version - Outlet Range 15 - 110 mbar
RG050 - MP - H	Gas Regulator 2" - 2" - Pmax 20 bar - MP Version - Outlet Range 70 - 300 mbar
RG050 - HP - H	Gas Regulator 2" - 2" - Pmax 20 bar - HP Version - Outlet Range 100 - 3000 mbar
Body DN40 - DN40 Flanged - HORIZONTAL VERSION - Without Relief Valve	
RGD40 - LP - H	Gas Regulator DN40 - DN40 - Pmax 10 bar - LP Version - Outlet Range 15 - 110 mbar
RGD40 - MP - H	Gas Regulator DN40 - DN40 - Pmax 20 bar - MP Version - Outlet Range 70 - 300 mbar
RGD40 - HP - H	Gas Regulator DN40 - DN40 - Pmax 20 bar - HP Version - Outlet Range 100 - 3000 mbar
Body DN50 - DN50 Flanged - HORIZONTAL VERSION - Without Relief Valve	
RGD50 - LP - H	Gas Regulator DN50 - DN50 - Pmax 10 bar - LP Version - Outlet Range 15 - 110 mbar
RGD50 - MP - H	Gas Regulator DN50 - DN50 - Pmax 20 bar - MP Version - Outlet Range 70 - 300 mbar
RGD50 - HP - H	Gas Regulator DN50 - DN50 - Pmax 20 bar - HP Version - Outlet Range 100 - 3000 mbar
Body 1" - 1" Threaded - VERTICAL VERSION	
RG025 - LP - RV - V	Gas Regulator 1" - 1" - Pmax 10 bar - LP Version - Outlet Range 15 - 110 mbar - Relief 15-110 mbar
RG025 - MP - RV - V	Gas Regulator 1" - 1" - Pmax 20 bar - MP Version - Outlet Range 70 - 300 mbar - Relief 80 - 1100 mbar
RG025 - HP - RV - V	Gas Regulator 1" - 1" - Pmax 20 bar - HP Version - Outlet Range 100 - 3000 mbar - Relief 80 - 3000 mbar
Body 1" - 1 1/2" Threaded - VERTICAL VERSION	
RG02540 - LP - RV - V	Gas Regulator 1" - 1 1/2" - Pmax 10 bar - LP Version - Outlet Range 15 - 110 mbar - Relief 15-110 mbar
RG02540 - MP - RV - V	Gas Regulator 1" - 1 1/2" - Pmax 20 bar - MP Version - Outlet Range 70 - 300 mbar - Relief 80 - 1100 mbar
RG02540 - HP - RV - V	Gas Regulator 1" - 1 1/2" - Pmax 20 bar - HP Version - Outlet Range 100 - 3000 mbar - Relief 80 - 3000 mbar
Body 1 1/2" - 1 1/2" Threaded - VERTICAL VERSION	
RG040 - LP - RV - V	Gas Regulator 1 1/2" - 1 1/2" - Pmax 10 bar - LP Version - Outlet Range 15 - 110 mbar - Relief 15-110 mbar
RG040 - MP - RV - V	Gas Regulator 1 1/2" - 1 1/2" - Pmax 20 bar - MP Version - Outlet Range 70 - 300 mbar - Relief 80 - 1100 mbar
RG040 - HP - RV - V	Gas Regulator 1 1/2" - 1 1/2" - Pmax 20 bar - HP Version - Outlet Range 100 - 3000 mbar - Relief 80 - 3000 mbar
Body 2" - 2" Threaded - VERTICAL VERSION	
RG050 - LP - RV - V	Gas Regulator 2" - 2" - Pmax 10 bar - LP Version - Outlet Range 15 - 110 mbar - Relief 15-110 mbar
RG050 - MP - RV - V	Gas Regulator 2" - 2" - Pmax 20 bar - MP Version - Outlet Range 70 - 300 mbar - Relief 80 - 1100 mbar
RG050 - HP - RV - V	Gas Regulator 2" - 2" - Pmax 20 bar - HP Version - Outlet Range 100 - 3000 mbar - Relief 80 - 3000 mbar
Body DN40 - DN40 Flanged - VERTICAL VERSION	
RGD40 - LP - RV - V	Gas Regulator DN40 - DN40 - Pmax 10 bar - LP Version - Outlet Range 15 - 110 mbar - Relief 15-110 mbar
RGD40 - MP - RV - V	Gas Regulator DN40 - DN40 - Pmax 20 bar - MP Version - Outlet Range 70 - 300 mbar - Relief 80 - 1100 mbar
RGD40 - HP - RV - V	Gas Regulator DN40 - DN40 - Pmax 20 bar - HP Version - Outlet Range 100 - 3000 mbar - Relief 80 - 3000 mbar
Body DN50 - DN50 Flanged - VERTICAL VERSION	
RGD50 - LP - RV - V	Gas Regulator DN50 - DN50 - Pmax 10 bar - LP Version - Outlet Range 15 - 110 mbar - Relief 15-110 mbar
RGD50 - MP - RV - V	Gas Regulator DN50 - DN50 - Pmax 20 bar - MP Version - Outlet Range 70 - 300 mbar - Relief 80 - 1100 mbar
RGD50 - HP - RV - V	Gas Regulator DN50 - DN50 - Pmax 20 bar - HP Version - Outlet Range 100 - 3000 mbar - Relief 80 - 3000 mbar

Range mentioned in above description is the full range . It is possible to get with different springs. \ Please select the right spring from the table in the product catalogue.

CODE	DESCRIPTION
Body 1" - 1" Threaded - VERTICAL VERSION - Without Relief Valve	
RG025 - LP - V	Gas Regulator 1" - 1" - Pmax 10 bar - LP Version - Outlet Range 15 - 110 mbar
RG025 - MP - V	Gas Regulator 1" - 1" - Pmax 20 bar - MP Version - Outlet Range 70 - 300 mbar
RG025 - HP - V	Gas Regulator 1" - 1" - Pmax 20 bar - HP Version - Outlet Range 100 - 3000 mbar
Body 1" - 1 1/2" Threaded - VERTICAL VERSION - Without Relief Valve	
RG02540 - LP - V	Gas Regulator 1" - 1 1/2" - Pmax 10 bar - LP Version - Outlet Range 15 - 110 mbar
RG02540 - MP - V	Gas Regulator 1" - 1 1/2" - Pmax 20 bar - MP Version - Outlet Range 70 - 300 mbar
RG02540 - HP - V	Gas Regulator 1" - 1 1/2" - Pmax 20 bar - HP Version - Outlet Range 100 - 3000 mbar
Body 1 1/2" - 1 1/2" Threaded - VERTICAL VERSION - Without Relief Valve	
RG040 - LP - V	Gas Regulator 1 1/2" - 1 1/2" - Pmax 10 bar - LP Version - Outlet Range 15 - 110 mbar
RG040 - MP - V	Gas Regulator 1 1/2" - 1 1/2" - Pmax 20 bar - MP Version - Outlet Range 70 - 300 mbar
RG040 - HP - V	Gas Regulator 1 1/2" - 1 1/2" - Pmax 20 bar - HP Version - Outlet Range 100 - 3000 mbar
Body 2" - 2" Threaded - VERTICAL VERSION - Without Relief Valve	
RG050 - LP - V	Gas Regulator 2" - 2" - Pmax 10 bar - LP Version - Outlet Range 15 - 110 mbar
RG050 - MP - V	Gas Regulator 2" - 2" - Pmax 20 bar - MP Version - Outlet Range 70 - 300 mbar
RG050 - HP - V	Gas Regulator 2" - 2" - Pmax 20 bar - HP Version - Outlet Range 100 - 3000 mbar
Body DN40 - DN40 Flanged - VERTICAL VERSION - Without Relief Valve	
RGD40 - LP - V	Gas Regulator DN40 - DN40 - Pmax 10 bar - LP Version - Outlet Range 15 - 110 mbar
RGD40 - MP - V	Gas Regulator DN40 - DN40 - Pmax 20 bar - MP Version - Outlet Range 70 - 300 mbar
RGD40 - HP - V	Gas Regulator DN40 - DN40 - Pmax 20 bar - HP Version - Outlet Range 100 - 3000 mbar
Body DN50 - DN50 Flanged - VERTICAL VERSION - Without Relief Valve	
RGD50 - LP - V	Gas Regulator DN50 - DN50 - Pmax 10 bar - LP Version - Outlet Range 15 - 110 mbar
RGD50 - MP - V	Gas Regulator DN50 - DN50 - Pmax 20 bar - MP Version - Outlet Range 70 - 300 mbar
RGD50 - HP - V	Gas Regulator DN50 - DN50 - Pmax 20 bar - HP Version - Outlet Range 100 - 3000 mbar
Slam Shut Valve for RG Regulator - OPSO/UPS0	
SSV-LP	Slam Shut valve for RG Regulator LP Version - OPSO range 30 - 180 mbar / UPSO range 6 - 60 mbar
SSV-MP	Slam Shut valve for RG Regulator MP Version - OPSO range 50 - 850 mbar / UPSO range 6 - 500 mbar
SSV-HP	Slam Shut valve for RG Regulator HP Version - OPSO range 180 - 5500 mbar / UPSO range 60 - 3500 mbar
Slam Shut Valve for RG Regulator - OPSO	
SSV-LP - OPSO	Slam Shut valve for RG Regulator - LP Version - Only OPSO range 30 - 180 mbar
SSV-MP - OPSO	Slam Shut valve for RG Regulator - MP Version - Only OPSO range 50 - 850 mbar
SSV-HP - OPSO	Slam Shut valve for RG Regulator - HP Version - Only OPSO range 180 - 5500 mbar
Slam Shut Valve for RG Regulator - UPSO	
SSV-LP - UPSO	Slam Shut valve for RG Regulator - LP Version - Only UPSO range 6 - 60 mbar
SSV-MP - UPSO	Slam Shut valve for RG Regulator - MP Version - Only UPSO range 6 - 500 mbar
SSV-HP - UPSO	Slam Shut valve for RG Regulator - HP Version - Only UPSO range 60 - 3500 mbar

Range mentioned in above description is the full range . It is possible to get with different springs. \ Please select the right spring from the table in the product catalogue.

CODE	COLOR	RANGE (mbar)	TYPE OF PRODUCT
OUTLET			
SPW-RG	White	15 - 20	LP
SPBK-RG	Black	20 - 30	LP
SPY-RG	Yellow	30 - 40	LP
SPR-RG	Red	40 - 70	LP
SPLB-RG	Light Blue	70 - 110	LP/MP
SPB-RG	Blue	100 - 180	MP/HP
SPBR-RG	Brown	180 - 300	MP/HP
SPGR-RG	Grey	300 - 700	HP
SPOR-RG	Orange	700 - 1100	HP
SPPU-RG	Purple	1100 - 2000	HP
SPN-RG	Neutral	2000 - 3000	HP
RELIEF VALVE			
SPLB-RV	Light Blue	15 - 40	LP
SPG-RV	Green	40 - 110	LP
SPR-RV	Red	80 - 1100	MP/HP
SPBK-RV	Black	1000 - 3000	HP
OPSO			
SPN-OPSO	Neutral	30 - 50	LP
SPLB-OPSO	Light Blue	50 - 180	LP/MP
SPG-OPSO	Green	180 - 550	MP/HP
SPY-OPSO	Yellow	280 - 850	MP/HP
SPB-OPSO	Blue	850 - 1400	HP
SPOR-OPSO	Orange	1400 - 2500	HP
SPBK-OPSO	Black	2500 - 4000	HP
SPR-OPSO	Red	4000 - 5500	HP
UPSO			
SPLB-UPSO	Light Blue	6 - 60	LP/MP
SPR-UPSO	Red	60 - 500	MP/HP
SPBK-UPSO	Black	500 - 1000	HP
SPY-UPSO	Yellow	1000 - 2000	HP
SPB-UPSO	Blue	2000 - 3500	HP

Gas regulator 1" - 1" / Horizontal Head

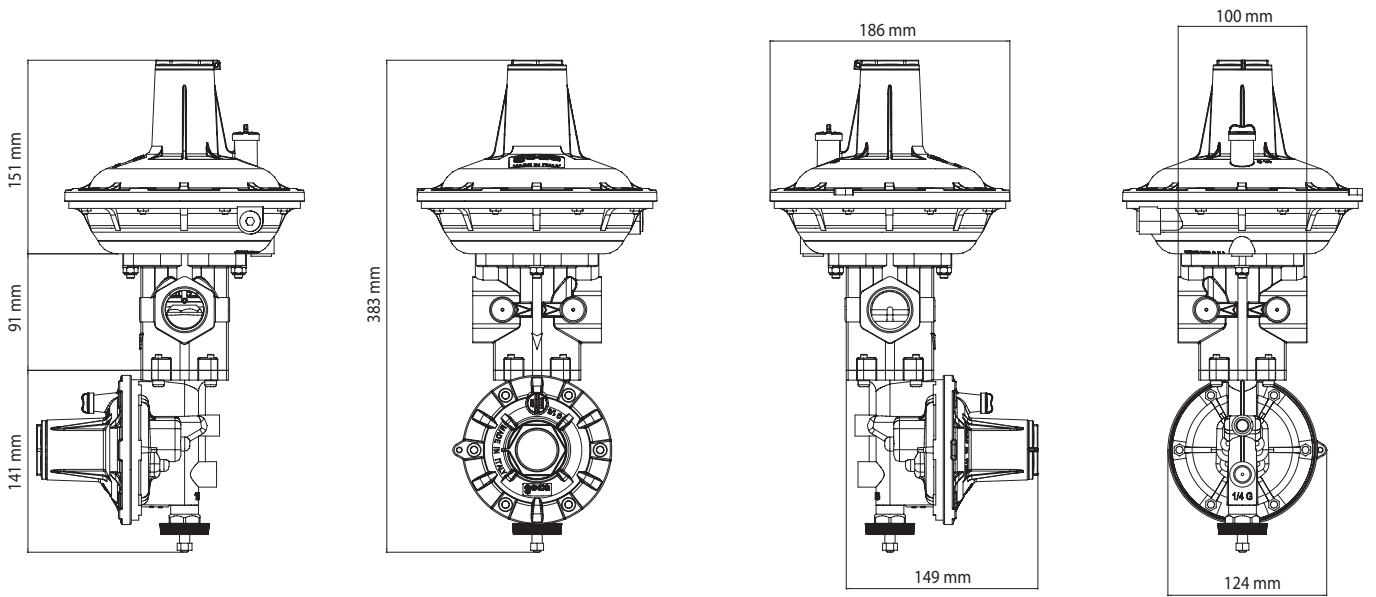

Gas regulator 1" - 1 1/2" / Horizontal Head

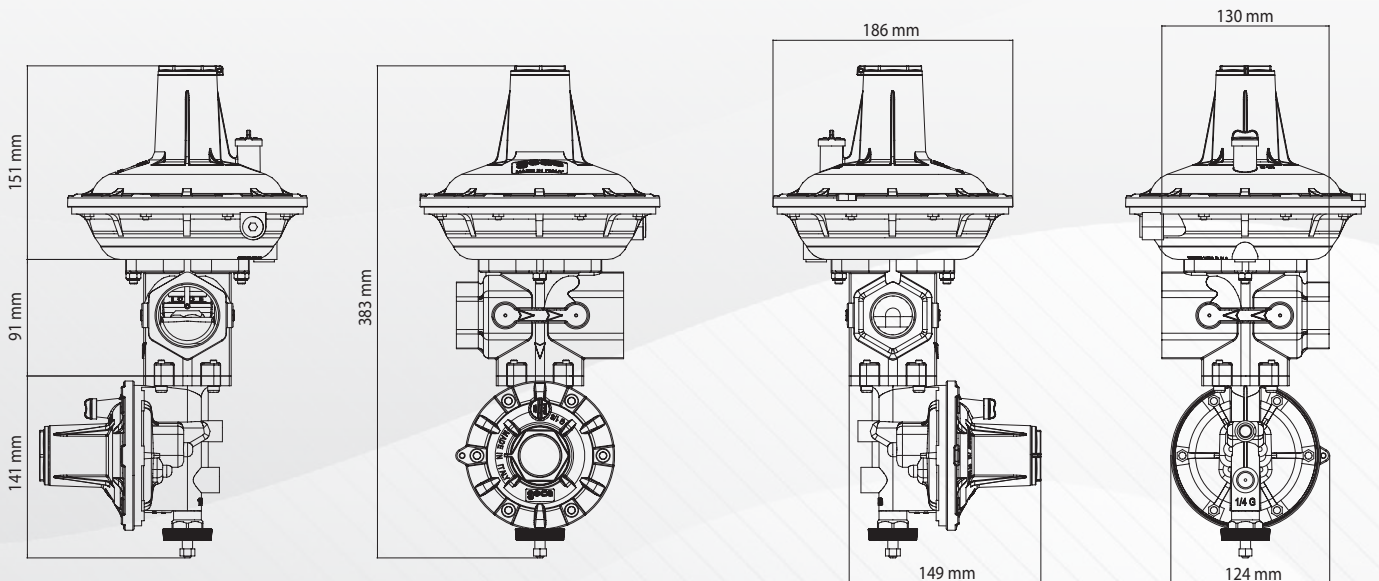

Gas regulator 1 1/2" - 1 1/2" / 2" - 2" / Horizontal Head

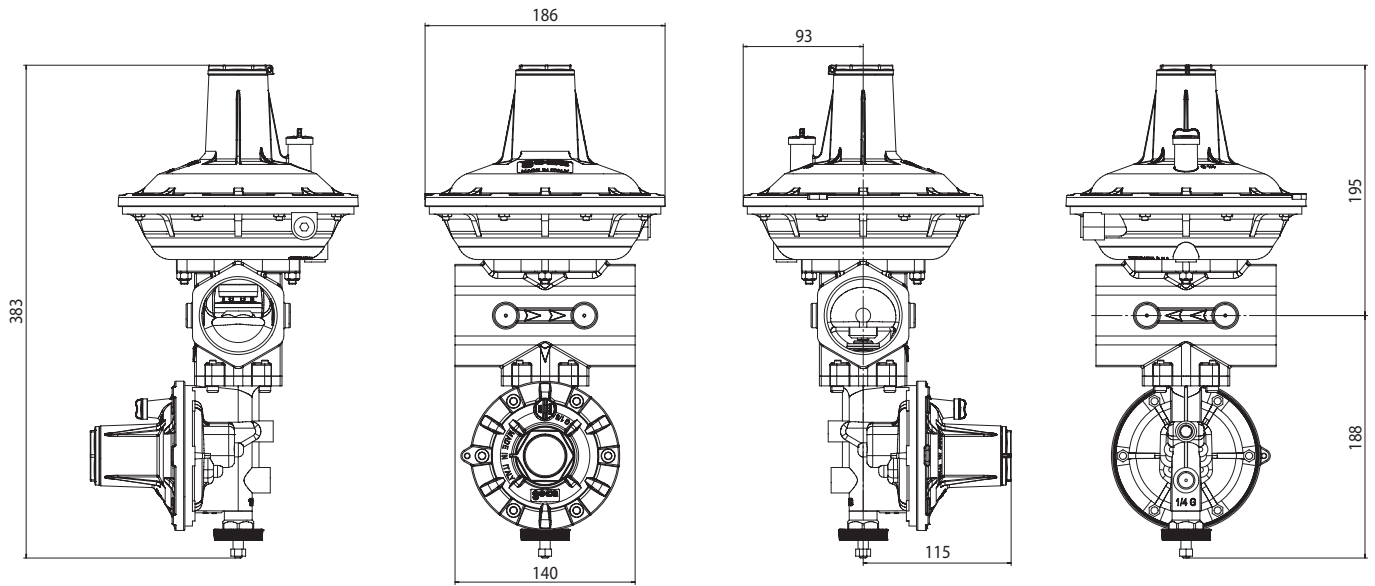

Gas regulator DN40 - DN40 / DN50 - DN50 / Horizontal Head

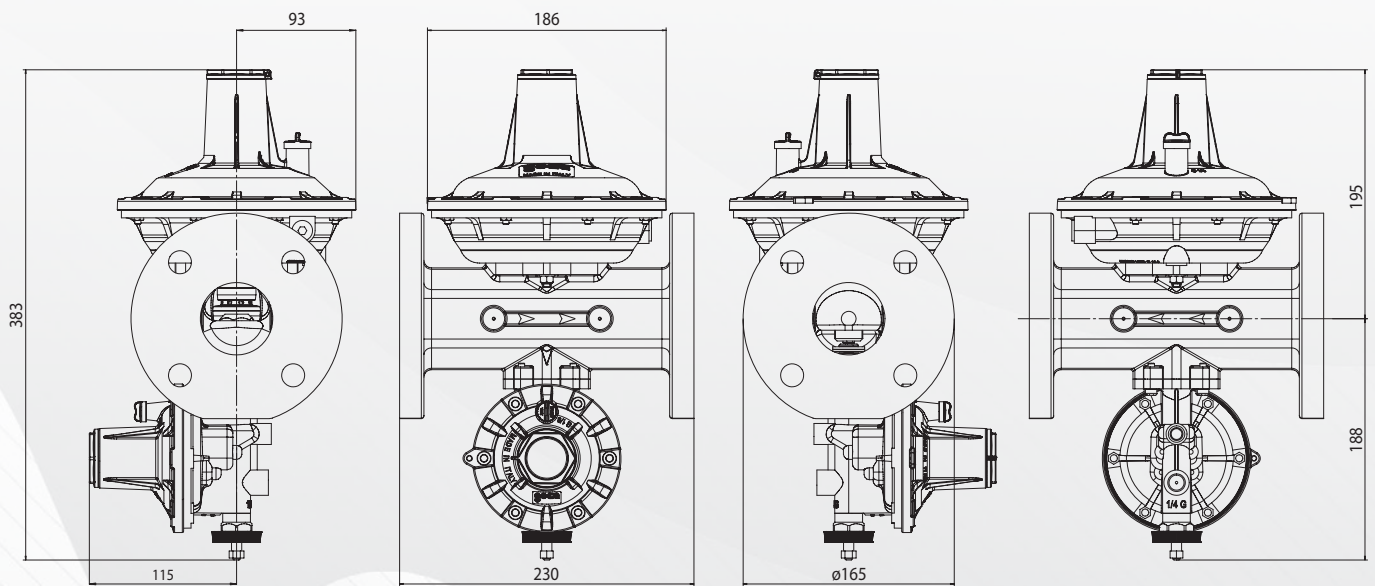

Gas regulator 1" - 1" / Vertical Head

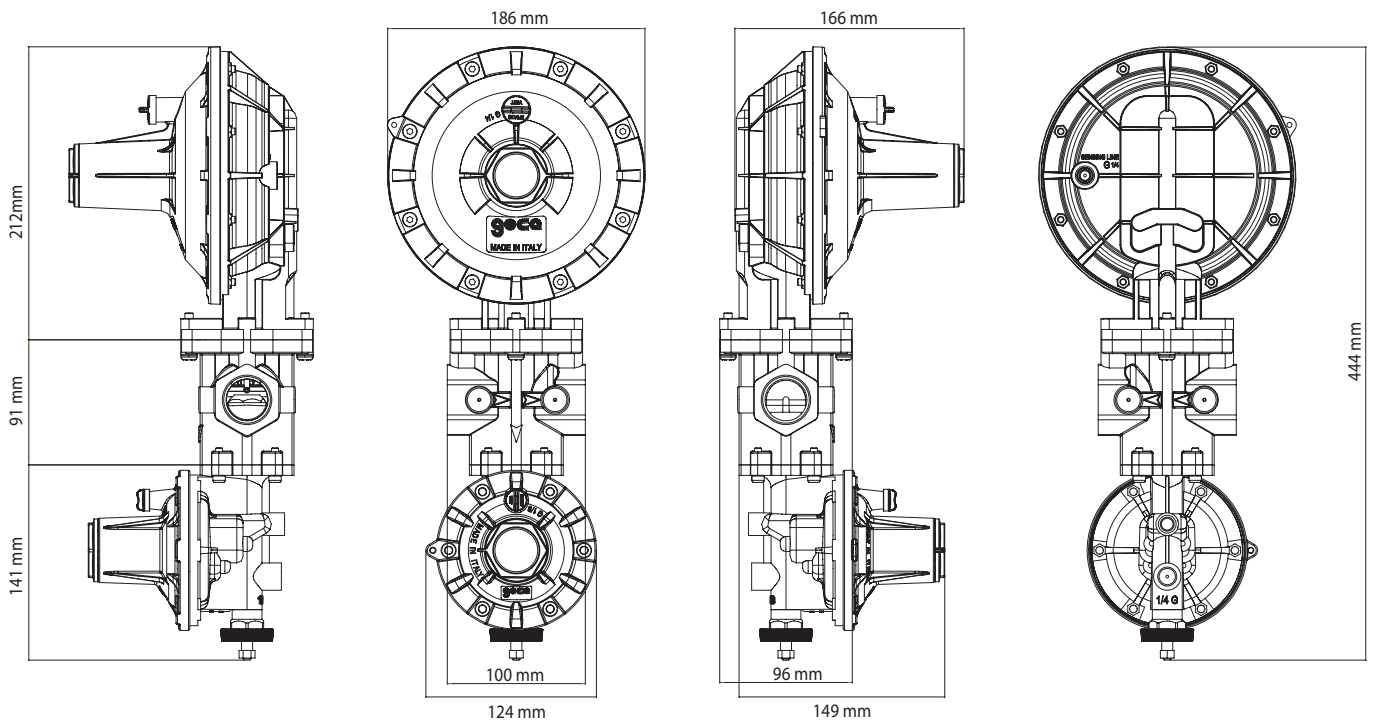

Gas regulator 1" - 1 1/2" / Vertical Head

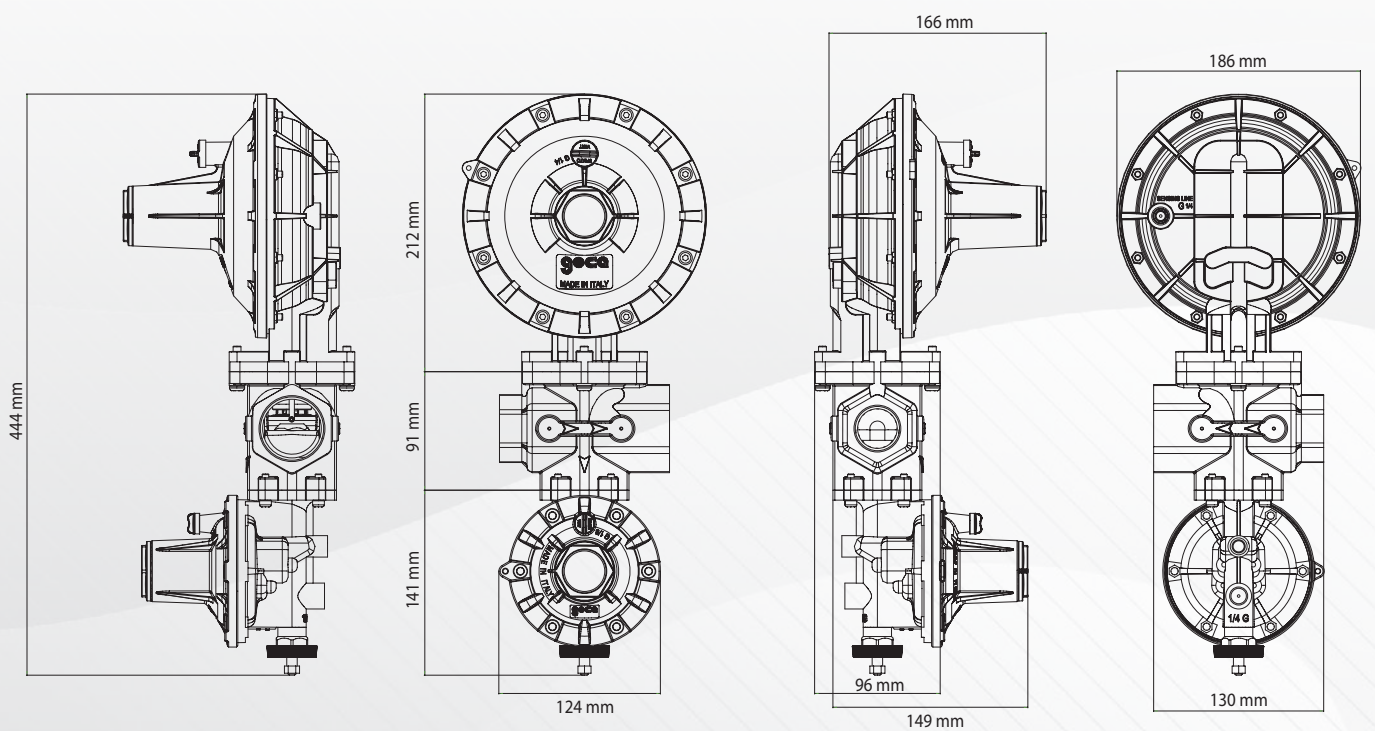

Gas regulator 1 1/2" - 1 1/2" / 2" - 2" / Vertical Head

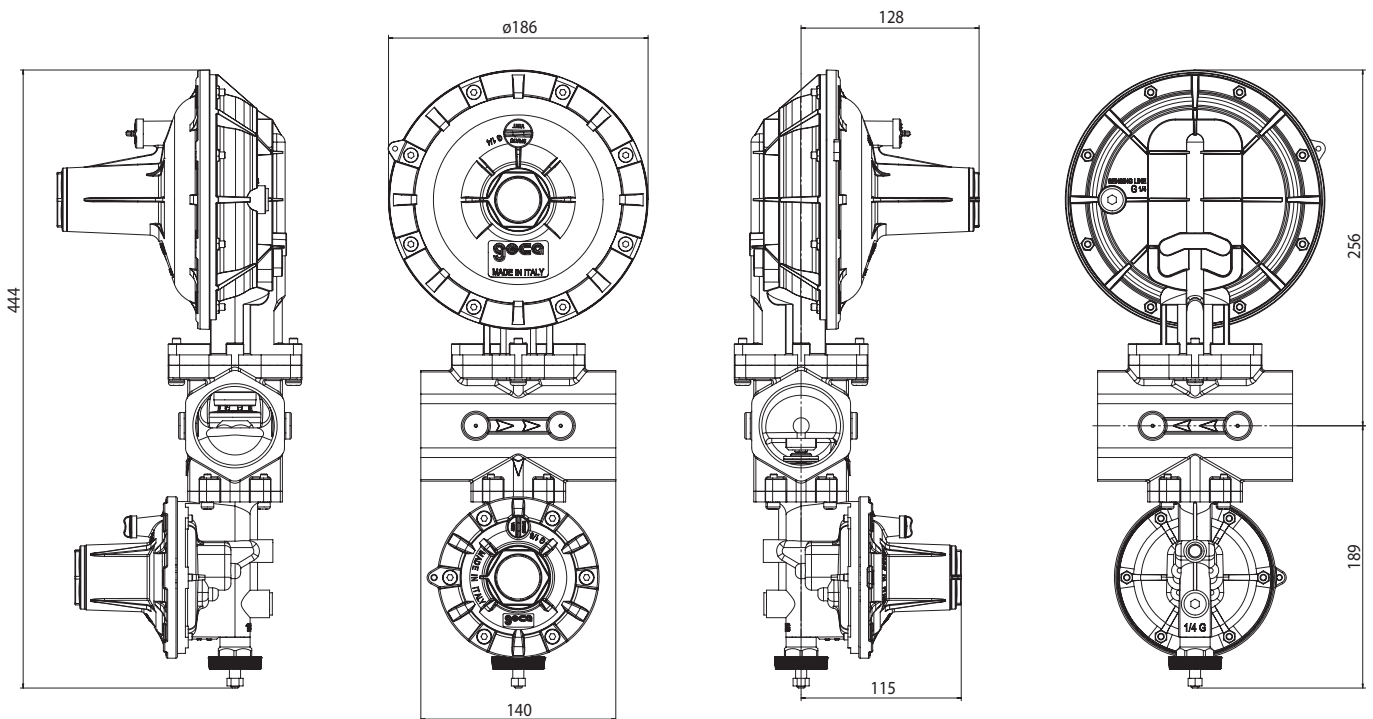

Gas regulator DN40 - DN40 / DN50 - DN50 / Vertical Head

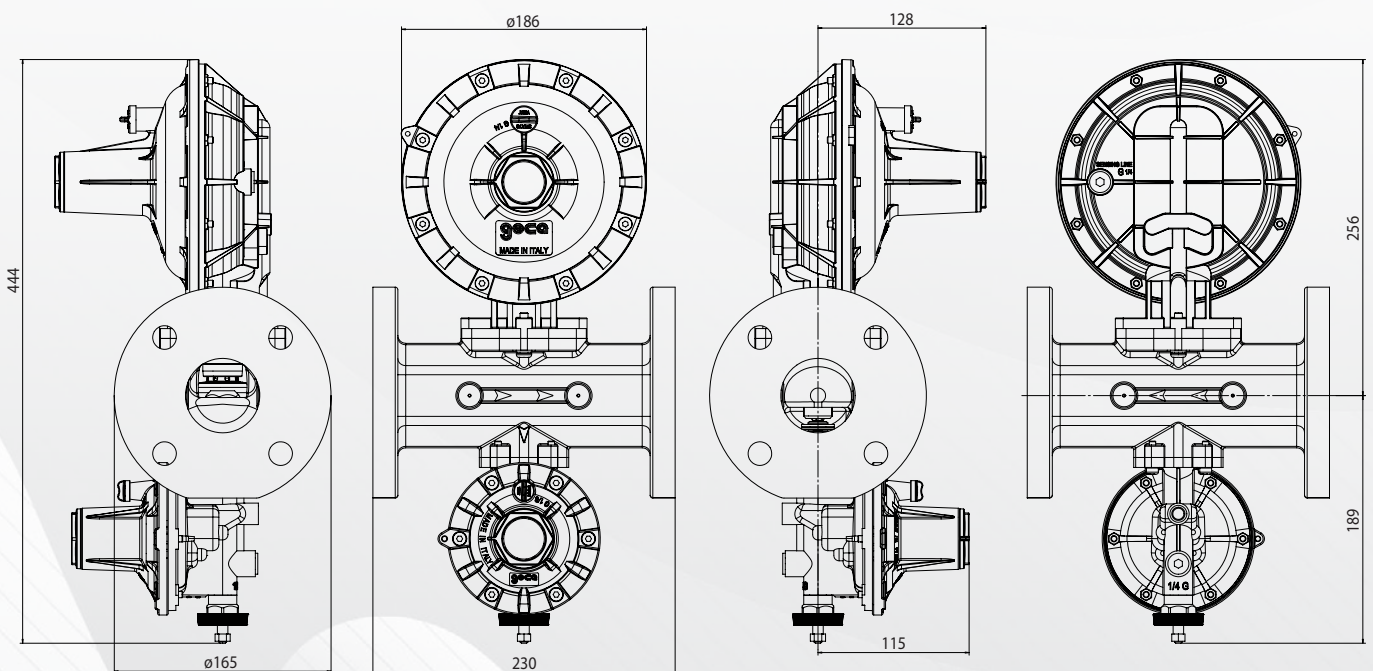

TECHNICAL DRAWING

Gas regulator / Horizontal Head

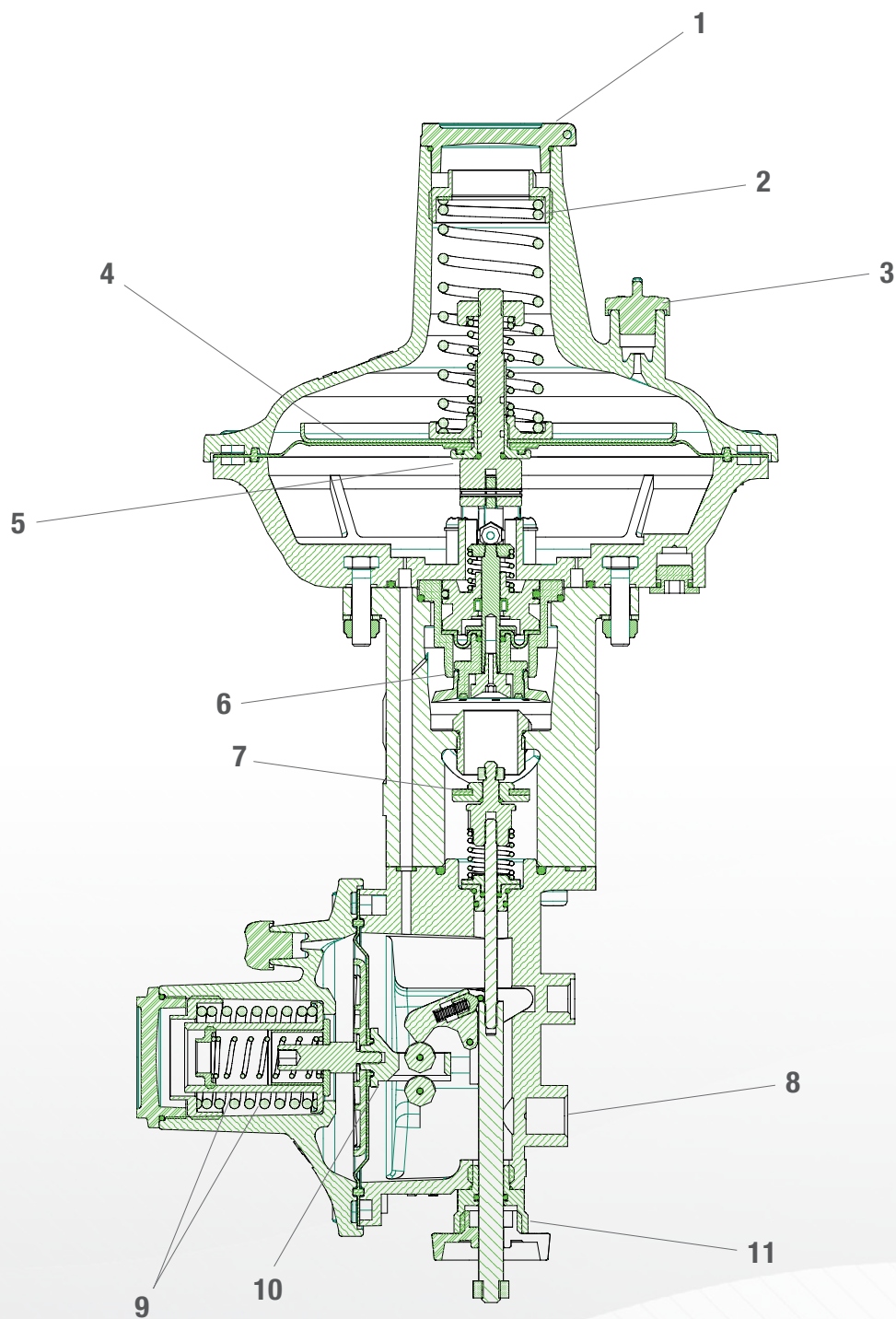

1. Seal cap

2. Setting spring

3. Vent line

4. Pressure detecting membrane

5. Relief valve

6. Control valve

7. Shutting valve

8. Sensing line

9. Upso/Opso setting springs

10. Release mechanism

11. Arming handle

TECHNICAL DRAWING

Gas regulator / Vertical Head

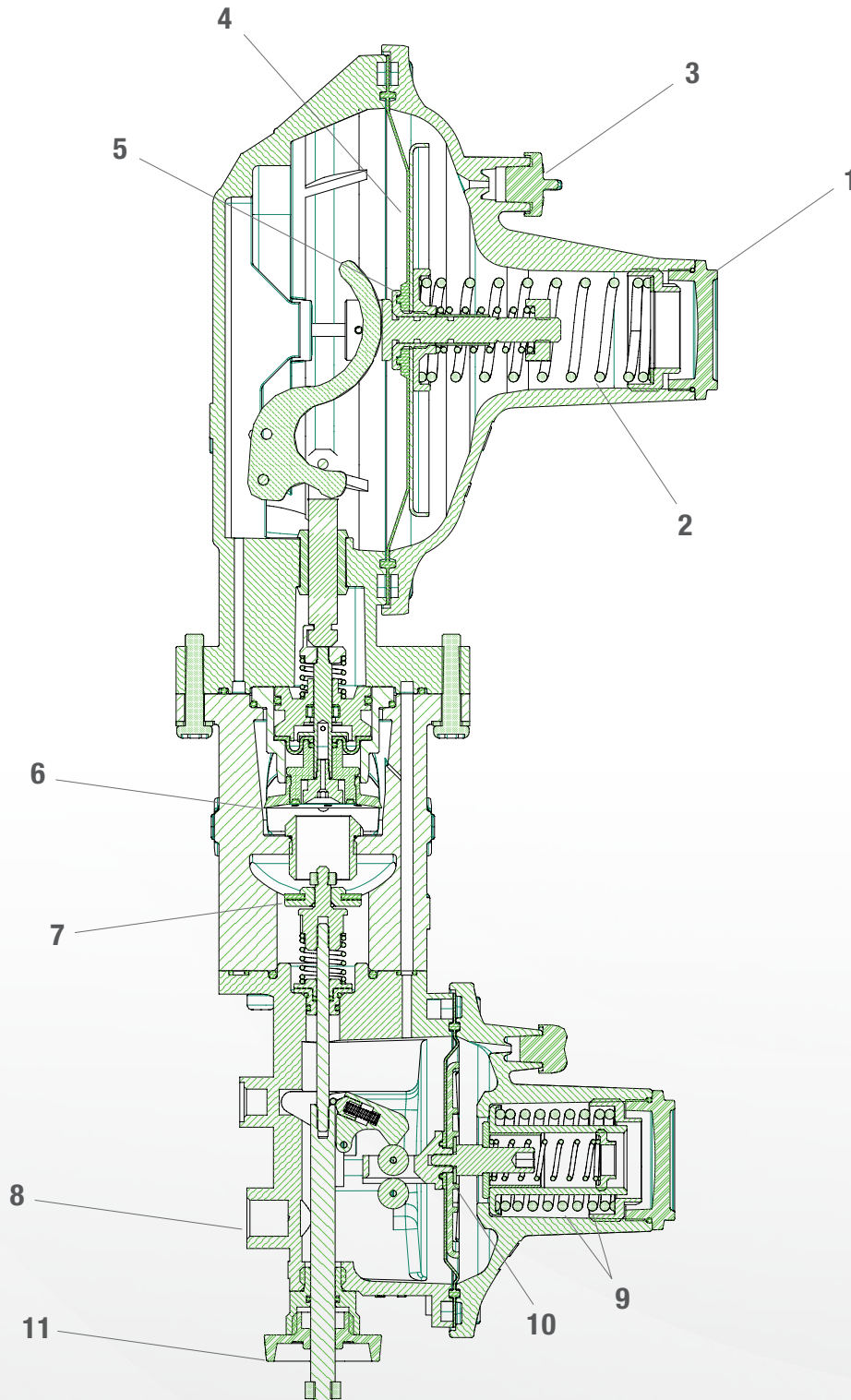

- | | | |
|--------------------------------|-------------------|------------------------------|
| 1. Seal cap | 5. Relief valve | 9. Upso/Opso setting springs |
| 2. Setting spring | 6. Control valve | 10. Release mechanism |
| 3. Vent line | 7. Shutting valve | 11. Arming handle |
| 4. Pressure detecting membrane | 8. Sensing line | |

FLOW CAPACITY

Gas Regulator 1"- 1" / Capacity stm^3/h

(Conversion in Kg/h = Multiply by 1,2)

Inlet Pressure Pu	Pd 25 mbar	Pd 35 mbar	Pd 50 mbar	Pd 100 mbar
200 mbar	35	34	32	25
300 mbar	43	42	41	38
500 mbar	57	56	55	53
1 bar	84	83	82	81
1,5 bar	106	106	105	105
2 bar	128	128	127	127
3 bar	170	170	170	170
5 bar	211	211	211	211

Inlet Pressure Pu	Pd 110 mbar	Pd 150 mbar	Pd 200 mbar	Pd 300 mbar
300 mbar	65	59	49	
500 mbar	93	89	84	72
1 bar	143	141	140	135
1,5 bar	185	184	183	181
2 bar	225	224	224	222
3 bar	251	260	271	293
5 bar	251	260	271	293

Inlet Pressure Pu	Pd 350 mbar	Pd 500 mbar	Pd 700 mbar	Pd 1000 mbar	Pd 1500 mbar	Pd 3000 mbar
2	129	127	123	115	91	
3	174	173	172	169	158	140
4	217	217	217	215	210	201
5	260	260	260	260	257	252
8	304	338	383	389	390	389
10	304	338	383	450	475	476
12	304	338	383	450	559	561
15 -20 bar	304	338	383	450	562	675

• The above table gives the maximum flow capacity.

• Above capacity are calculated with external sensing line.

FLOW CAPACITY

Gas Regulator 1" - 1 1/2" / Capacity stm³/h

(Conversion in Kg/h = Multiply by 1,2)

Inlet Pressure Pu	Pd 25 mbar	Pd 35 mbar	Pd 50 mbar	Pd 100 mbar
200 mbar	45	44	42	35
300 mbar	56	55	54	49
500 mbar	74	73	72	69
1 bar	108	108	107	106
1,5 bar	138	138	138	137
2 bar	167	167	167	167
3 bar	222	222	222	222
5 bar	330	330	330	331

Inlet Pressure Pu	Pd 110 mbar	Pd 150 mbar	Pd 200 mbar	Pd 300 mbar
300 mbar	88	80	67	
500 mbar	154	148	140	98
1 bar	195	193	190	184
1,5 bar	252	251	250	247
2 bar	306	306	305	303
3 bar	410	410	410	409
5 bar	578	599	611	612

Inlet Pressure Pu	Pd 350 mbar	Pd 500 mbar	Pd 700 mbar	Pd 1000 mbar	Pd 1500 mbar	Pd 3000 mbar
2	141	139	135	126	99	
3	191	190	188	185	174	153
4	238	238	238	236	231	220
5	285	285	285	282	282	276
8	423	424	425	426	428	427
10	514	516	517	519	521	522
12	606	607	608	611	614	616
15 -20 bar	703	781	885	141	1064	1069

• The above table gives the maximum flow capacity.

• Above capacity are calculated with external sensing line.

FLOW CAPACITY

Gas Regulator 1 1/2" - 1 1/2" / DN40 - DN40 / Capacity stm^3/h

(Conversion in Kg/h = Multiply by 1,2)

Inlet Pressure Pu	Pd 25 mbar	Pd 35 mbar	Pd 50 mbar	Pd 100 mbar
200 mbar	56	55	53	44
300 mbar	70	69	68	61
500 mbar	93	91	90	86
1 bar	135	135	134	133
1,5 bar	173	173	173	171
2 bar	209	209	209	209
3 bar	278	278	278	278
5 bar	413	413	413	414

Inlet Pressure Pu	Pd 110 mbar	Pd 150 mbar	Pd 200 mbar	Pd 300 mbar
300 mbar	110	100	84	
500 mbar	193	185	175	123
1 bar	244	241	238	230
1,5 bar	315	314	313	309
2 bar	383	383	381	379
3 bar	513	513	513	511
5 bar	723	749	764	765

Inlet Pressure Pu	Pd 350 mbar	Pd 500 mbar	Pd 700 mbar	Pd 1000 mbar	Pd 1500 mbar	Pd 3000 mbar
2	176	174	169	158	124	
3	239	238	235	231	218	191
4	298	298	298	295	289	275
5	356	356	356	353	353	345
8	529	530	531	533	535	534
10	643	645	646	649	651	653
12	758	759	760	764	768	770
15 -20 bar	879	976	1106	176	1330	1336

• The above table gives the maximum flow capacity.

• Above capacity are calculated with external sensing line.

FLOW CAPACITY

Gas Regulator 2" - 2" / DN50 - DN50 / Capacity stm³/h

(Conversion in Kg/h = Multiply by 1,2)

Inlet Pressure Pu	Pd 25 mbar	Pd 35 mbar	Pd 50 mbar	Pd 100 mbar
200 mbar	62	61	58	48
300 mbar	77	76	74	67
500 mbar	102	100	99	95
1 bar	149	149	147	146
1,5 bar	190	190	190	188
2 bar	230	230	230	230
3 bar	305	305	305	305
5 bar	454	454	454	455

Inlet Pressure Pu	Pd 110 mbar	Pd 150 mbar	Pd 200 mbar	Pd 300 mbar
300 mbar	121	110	92	
500 mbar	212	204	193	135
1 bar	268	265	261	253
1,5 bar	347	345	344	340
2 bar	421	421	419	417
3 bar	564	564	564	562
5 bar	795	824	840	842

Inlet Pressure Pu	Pd 350 mbar	Pd 500 mbar	Pd 700 mbar	Pd 1000 mbar	Pd 1500 mbar	Pd 3000 mbar
2	194	191	186	173	136	
3	263	261	259	254	239	210
4	327	327	327	325	318	303
5	392	392	392	388	388	380
8	582	583	584	586	589	587
10	707	710	711	714	716	718
12	833	835	836	840	844	847
15 -20 bar	967	1074	1217	194	1463	1470

• The above table gives the maximum flow capacity.

• Above capacity are calculated with external sensing line.

PRODUCT RANGE OVERVIEW



GAS GOVERNOR

- Aluminum body
- From 1/2" to DN100
- 500 mbar / 1 bar / 2 bar / 5 bar



AUTOMATIC GAS VALVE

- Aluminum body
- From 1/2" to DN150
- 360 mbar / 6 bar
- Fast opening / Fast closing
- Slow opening / Fast closing

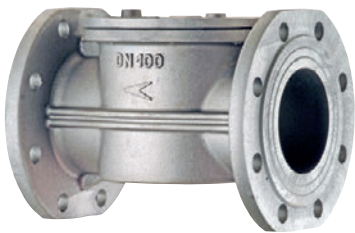

GAS FILTER

- Aluminum body
- From 1/2" to DN200
- 6 bar / 10 bar



GAS SOLENOID VALVE

- Normally open or normally close
- 550 mbar or 6 bar
- From 1/2" to DN200
- 230 Vac – 12 Vdc/Vac – 24 Vdc/Vac / 110 Vac
- Manual / Automatic reset



Our policy of continuous product improvement, the features and data shown are subject to change without notice. The images of the products and accessories are only indicative. Graphic colors of the products may differ from reality.



geca

GECA S.r.l.
 Via E. Fermi, 98 | 25064 Gussago (BS) | ITALY
 Tel. +39 030 3730218
 Fax +39 030 3730228
 E-mail: info@gecasrl.it
gecasrl.it

**Tecno
control**

Tecnocontrol S.r.l.
 Via Miglioli, 47 | 20054 Segrate (MI) | ITALY
 Tel. +39 02 26922890
 Fax +39 02 2133734
 E-mail: info@tecnoccontrol.it
tecnoccontrol.it

**CPF
INDUSTRIALE**

CPF Industriale S.r.l.
 Via E. Fermi, 98 | 25064 Gussago (BS) | ITALY
 Tel. +39 030 310461
 Fax +39 030 310465
 E-mail: info@cpfindustriale.it
cpfindustriale.it

Marchi:

FRG
fagonline.com

YUKON
yukon-air-quality.com